

OFK-DC206

High Resolution Dome Camera



- ▶ 1/3" Sony Super HAD CCD, Digital Signal Processing (DSP)
- ▶ High Resolution: 420TVL
- ▶ Mini Illumination 0.1Lux/F1.2
- ▶ S/N ratio over 50dB
- ▶ AGC, AWB, BLC, ES
- ▶ Built-in integrative board lens f=3.6, 6, 8, 12, 16mm optional
- ▶ White and black casing selectable

Elegant Appearance, applying in concealing place

Natural color response & Outstanding picture quality

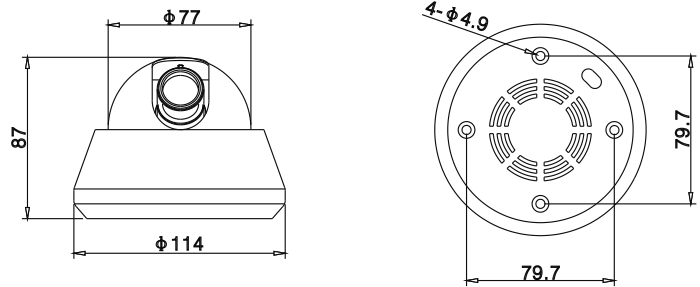

Specification

Model	OFK-DC206
Image pick up device	1/3" Sony Super HAD CCD
Signal system	PAL/NTSC color system
No. of effective pixels	PAL: 500(H)x582(V); NTSC: 510(H)x494(V)
Horizontal resolution	420TV Lines
S/N ratio	More than 50 dB
Minimum illumination	0.1Lux/F1.2
AGC/BLC	Automatic
AWB	Automatic
Electronic shutter	1/50-1/100,000sec (PAL), 1/60-1/100,000sec (NTSC)
Gamma correction	>0.45
Sync.Type	INT
Lens type	Fixed board lens f=3.6, 6, 8, 12, 16mm optional
Output signal	1.0Vp-p, 75Ohm, sync negative polarity
Power supply	DC 12V
Power consumed	110mA(Max)
Working temperature	-10°C~+50°C RH95% Max
Dimension	∅ 114x87mm
Weight	220g