

User's Manual for A4 Dimmer Smart Switch Series

Production Introduction

A4 Dimmer Smart Switches Series BC2-A1DI-B, BC2-A2DI-B, BC2-A3DI-B is one of the BECHAMP smart switch series. A4 Dimmer Smart Switch Series can replace traditional illuminating switches. They are the best choice for your modern Smart Home

Specification

Working voltage	AC180-250V
Dimmer way	25-800W(one key) 40-800W(two key) 60-800W(three key)
Non-dimmer way	5-1100W(per key)
Working Temperature	0-50°C
Working humidity	≤90%RH
Receiving sensitivity	-105dBm
Receiving frequency	433.92MHz
Load Type	Incandescence light/ Spot light

Cabling

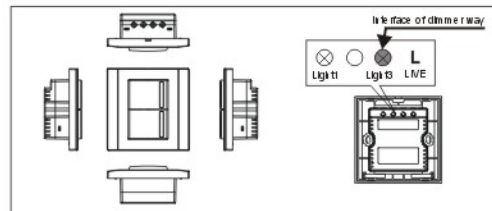
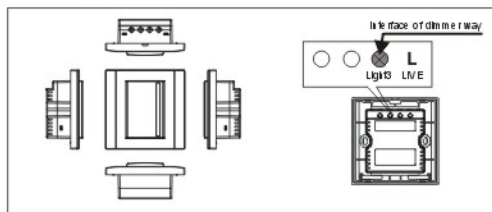

Caution

- 1) Make sure products are installed by professionals. Please turn off all power supply before installation.
- 2) DO NOT installed in bathroom.
- 3) Please check whether there is short circuit before installation.
- 4) Total power consumption of lights MUST NOT exceed the rating power
- 5) Dimmer switch only one dimmer gang and other Gangs are non-dimmer gangs..
- 6) Dimmer gang has to be connected with the light Otherwise the switch can't work..
- 7) Switch will execute current command before execute the next command issued by user. (It takes 1.5 second for Remote Controller to issue command before next)
- 8) Strongly recommend using light with approval

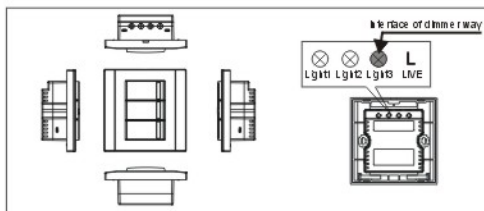

Installation

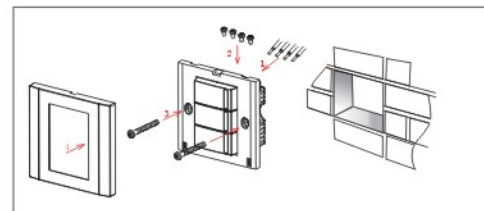

(CE, UL...etc.)

- 9) Adjust the power of the light if the light is glittering slightly.

Q&A

- Q1. Light is not on.
A1. Check the power.
A2. Light is damaged, please check & replace it.
A3. Incorrect wiring. Please read user manual and wire it up again.
A4. Not enough power consumption (less than 5W) for light bulb, please change to larger one.
- Q2. Glittering
A1. The light adapter does not match the switch. please change it.

Function:

- A. Wireless Control: Can use Remote Controller to control lighting's ON/OFF. (For details, please refer BC2-GGLR's user manual)
- B. Remote Control: Can be controlled by Internet or telephone by Touch Panel (BC2-50L) or Telephone Controller (BC2-ET01).
- C. Dimmer Function: Incandescence light or spot-light can be controlled for dimming. The switch will save the status and return to the brightness next time the switch is turned on.
- D. Unilateral Brightness Adjustment: Brightness will be changed unilaterally when you press the switch key. In case to adjust brightness in opposite, release the switch and hold the switch key to adjust.
- E. Luminous Indication: Indicate the location of switches in darkness.

Q3. Can't control by Remote Control

- A1. Please read the user manual of Remote Controller
- A2. Low batteries. Replace immediately.

Q4. Can't set up the scene configuration

- A1. Please check the scene code
- A2. The scene checked code was deleted. Please check scene code again

Q5. Damaged switch

- A1. Short circuit occurred during installation. Please check the circuit and replace a new switch
- A2. Power consumption overloaded. Please reduce total power consumption of light bulbs.